

Appendix B

Jaycee Park New Trail and Bridge Replacement – Trail Redesign Option 3

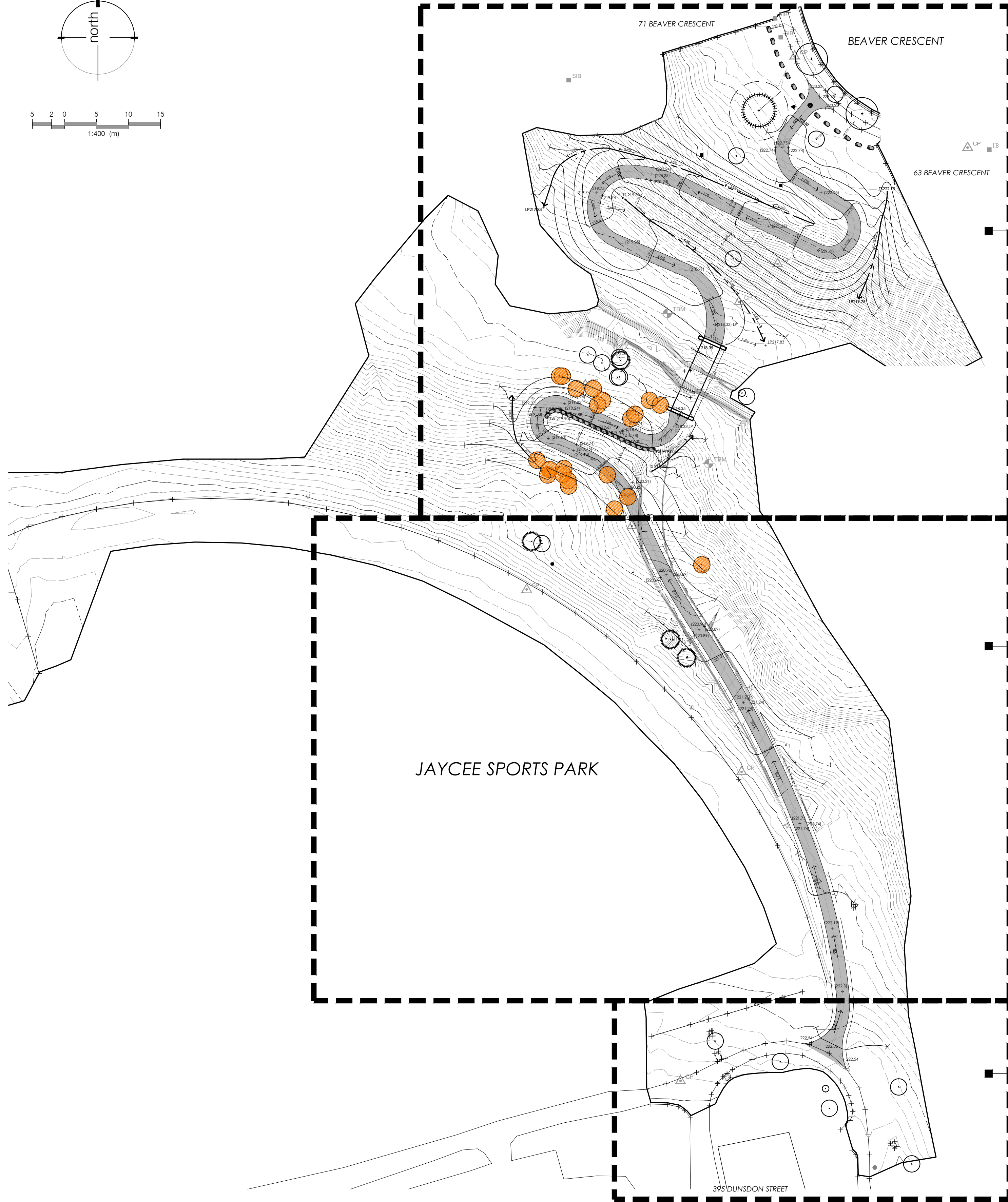
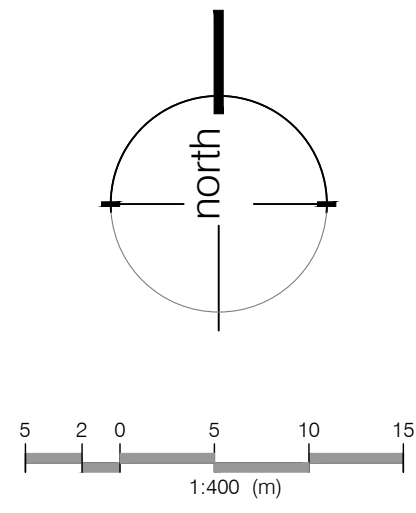

ENLARGEMENT 'A' - SEE SHEET No. 2-2439-3

ENLARGEMENT 'B' - SEE SHEET No. 2-2439-4

ENLARGEMENT 'C' - SEE SHEET No. 2-2439-5

OPTION 3 - SOUTHWEST MEANDER

- additional 33.68 linear metres of asphalt trail
- fill required between contours 219.5 and 221.00
- cut required between contours 218.5 to 222.00
- retaining required (approx. 19.0 linear metres)
- 21 extra tree for removal

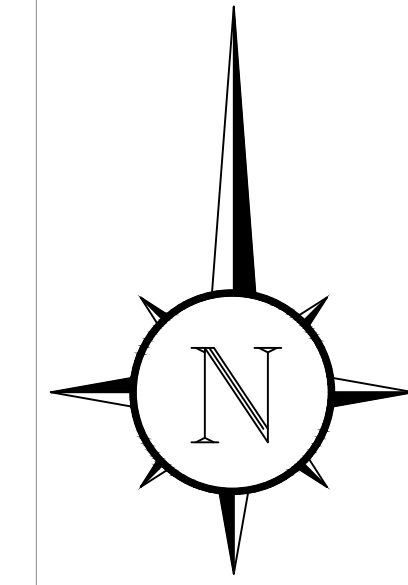

KEY PLAN
NOT TO SCALE

LEGEND

- existing tree to remain
- proposed deciduous tree
- proposed elevation
- proposed slope
- proposed 2.0m width asphalt path
- existing elevation
- proposed swale

LOCATIONS OF UNDERGROUND UTILITIES AS SHOWN ARE BASED ON THE BEST INFORMATION AVAILABLE, BUT NO GUARANTEE IS GIVEN THAT ALL EXISTING UTILITIES ARE SHOWN OR THAT THE GIVEN LOCATIONS ARE EXACT. CONFIRMATION OF EXISTENCE AND EXACT LOCATION OF ALL SERVICES MUST BE OBTAINED FROM THE INDIVIDUAL UTILITIES BEFORE PROCEEDING WITH CONSTRUCTION.

SURVEY NOTE REFERENCE:

5	Aug 26/24	Issued For Review	M.P.	c.d.
4	May 24/24	Issued For Construction	M.M.	c.p.
3	April 2/24	Issued For Tender Addendum	M.M.	v.d.
2	June 15/23	Issued For Tender	M.M.	v.d.

No.	DATE	REVISIONS	INIT.
DATE OF PLOT		August 26, 2024	



OVERALL TRAIL LAYOUT ON:

JAYCEE PARK TRAIL

From: BEAVER CRESCENT
To: DUNSDON STREET

APP'D.	DES.	RATIO: HORIZ. 1:250 VERT. 1:100
DESIGNED BY: MM/VD DRAWN BY: V. DAMONE CHECKED BY: M. PATTIUCO		DATE: AUGUST, 2024

MATCH LINE -
SEE SHEET No. 2-2439-3, ENLARGEMENT 'A'

MATCH LINE -
SEE SHEET No. 2-2439-3, ENLARGEMENT 'A'

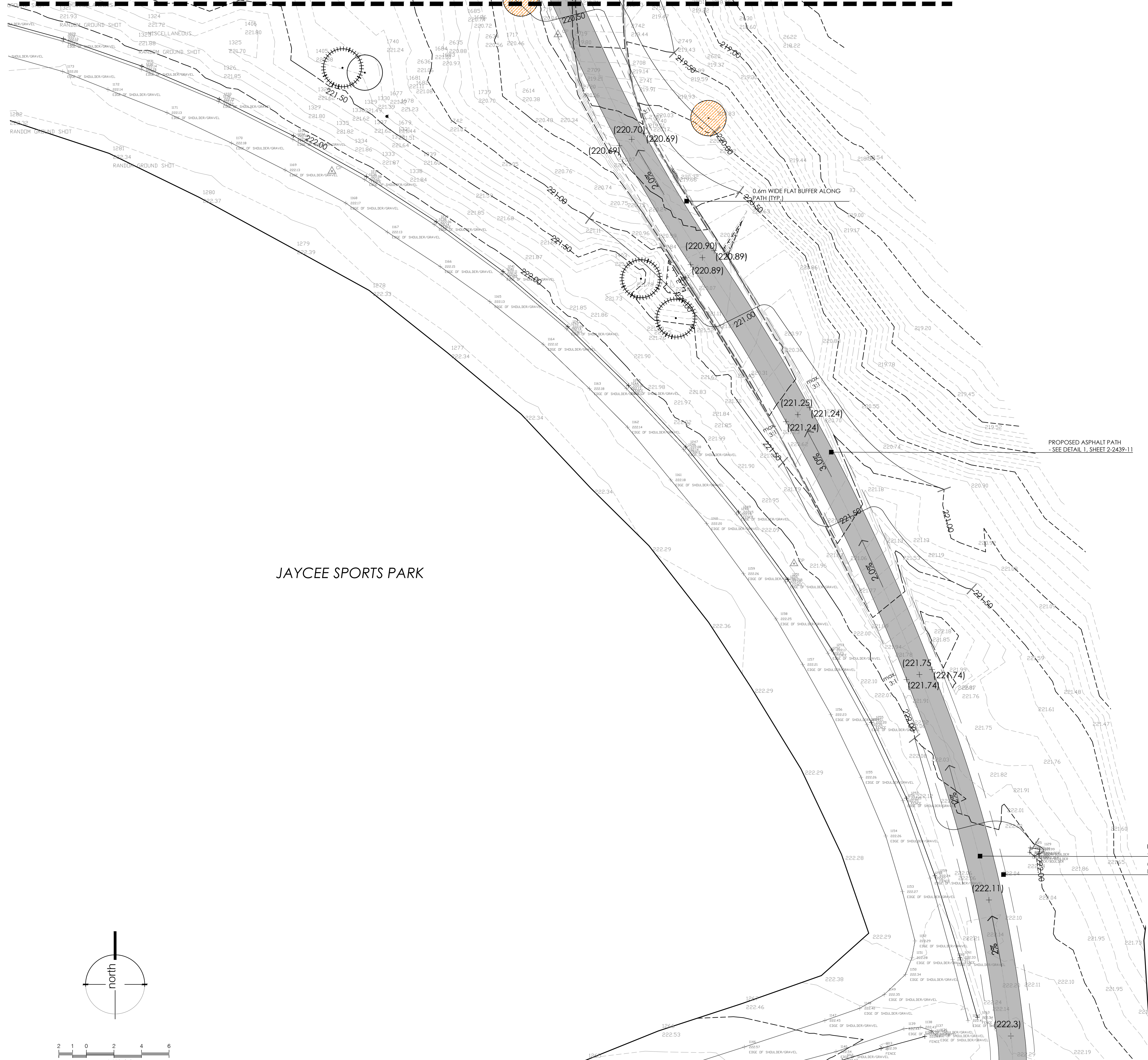

JAYCEE SPORTS PARK

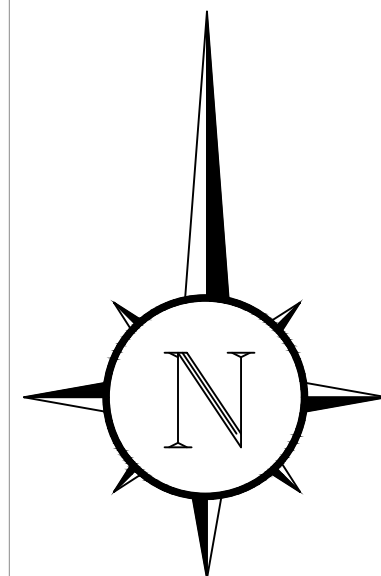

KEY PLAN
NOT TO SCALE

- LEGEND
- existing tree to remain
 - proposed deciduous tree
 - 217.83 proposed elevation
 - 2% proposed slope
 - proposed 2.0m width asphalt path
 - existing elevation

LOCATIONS OF UNDERGROUND UTILITIES AS SHOWN ARE BASED ON THE BEST INFORMATION AVAILABLE, BUT NO GUARANTEE IS GIVEN THAT ALL EXISTING UTILITIES ARE SHOWN OR THAT THE GIVEN LOCATIONS ARE EXACT. CONFIRMATION OF EXISTENCE AND EXACT LOCATION OF ALL SERVICES MUST BE OBTAINED FROM THE INDIVIDUAL UTILITIES BEFORE PROCEEDING WITH CONSTRUCTION.

SURVEY NOTE REFERENCE:

No.	DATE	REVISIONS	INIT.
5	Aug 21/24	Issued For Pricing	M.P. v.d.
4	May 24/24	Issued For Construction	M.M. c.p.
3	April 2/24	Issued For Tender Addendum	M.M. v.d.
2	June 15/23	Issued For Tender	M.M. v.d.

DATE OF PLOT August 21, 2024



LANDSCAPE PLAN - TRAIL ENLARGEMENT 'B'
JAYCEE PARK TRAIL
From: BEAVER CRESCENT
To: DUNSDON STREET

APP'D.	DES.	RATIO: HORIZ. 1:250 VERT. 1:100
DESIGNED BY: MM/VD DRAWN BY: V. DAMONE CHECKED BY: M. PATRUCCI		DATE: AUGUST, 2024
PROJECT No. PK 2226	DRAWING No. 2-2439-4	

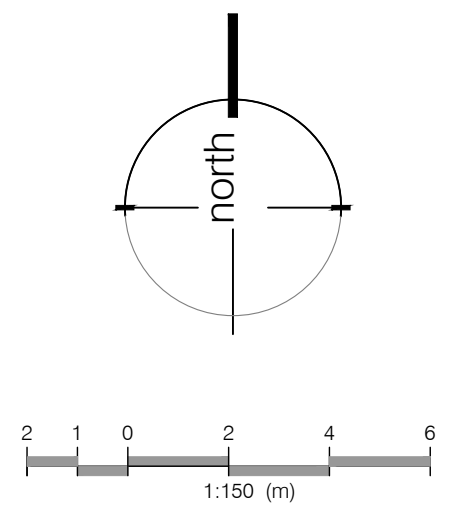

MATCH LINE - SEE SHEET No. 2-2439-5,
ENLARGEMENT 'C'

MATCH LINE - SEE SHEET No. 2-2439-5,
ENLARGEMENT 'C'

Z:\PROJECTS\FILES\PROJECTS_2023\2-2439_JAYCEE TRAIL BRANTFORD\01-CURRENT DRAWINGS\2-2439-04-PC-OPTIONS -SOUTH SHOTS

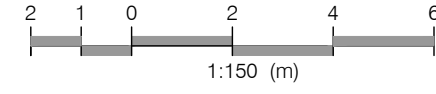
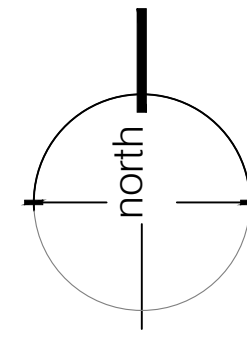

MATCH LINE -
SEE SHEET No. 2-2439-4,
ENLARGEMENT 'B'

MATCH LINE -
SEE SHEET No. 2-2439-4,
ENLARGEMENT 'B'

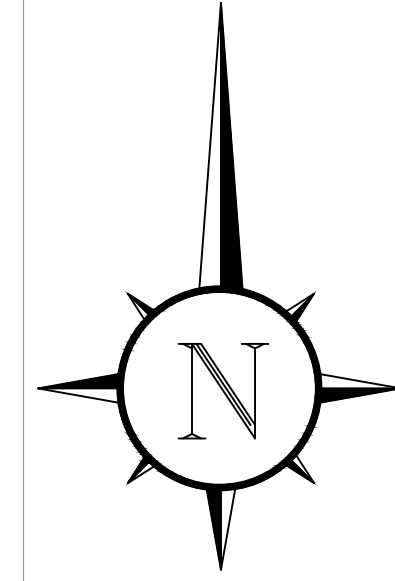
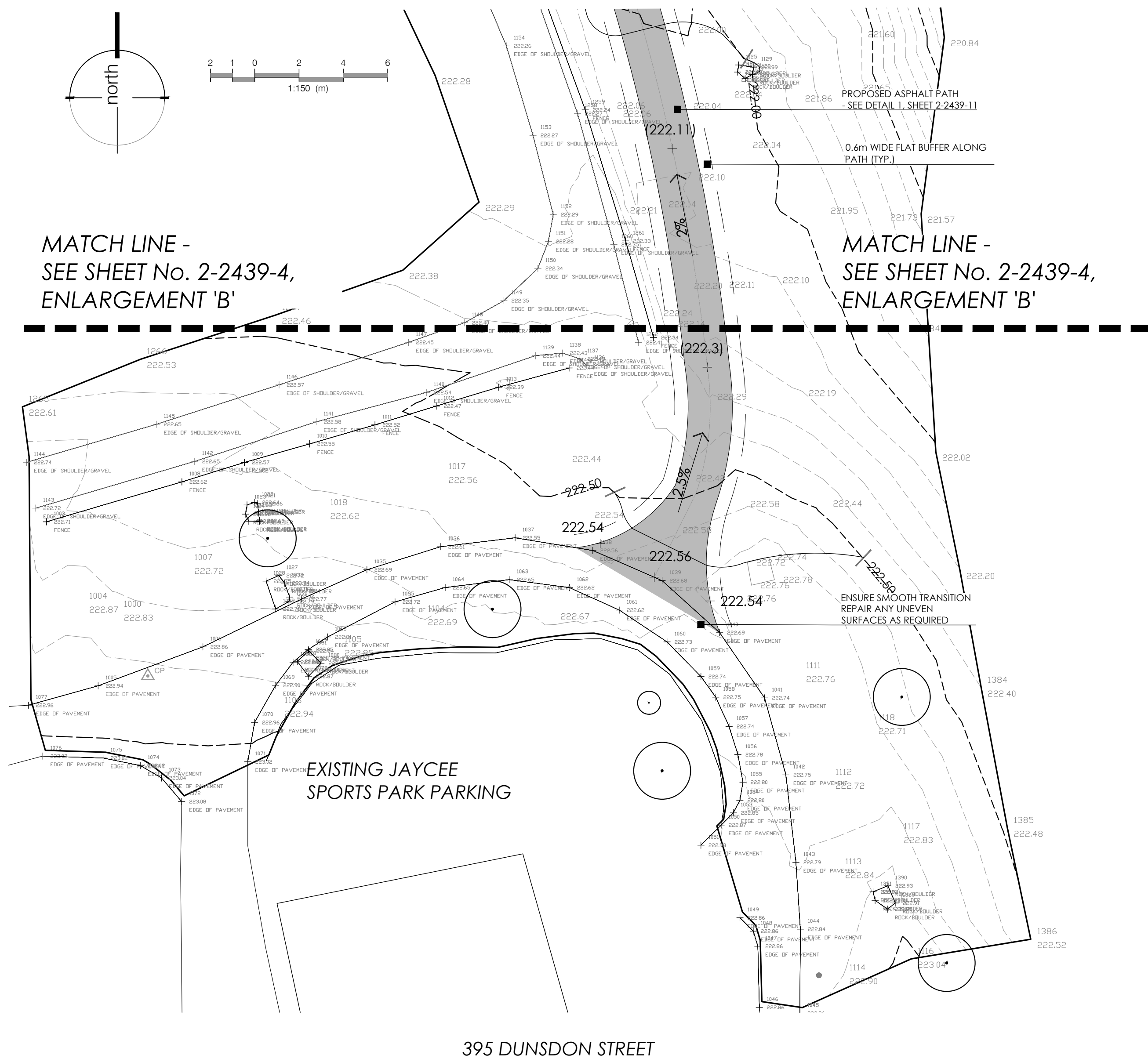

KEY PLAN
NOT TO SCALE

LEGEND

- existing tree to remain
- proposed deciduous tree
- 217.83 proposed elevation
- 2% proposed slope
- proposed 2.0m width asphalt path
- existing elevation

LOCATIONS OF UNDERGROUND UTILITIES AS SHOWN ARE BASED ON THE BEST INFORMATION AVAILABLE, BUT NO GUARANTEE IS GIVEN THAT ALL EXISTING UTILITIES ARE SHOWN OR THAT THE GIVEN LOCATIONS ARE EXACT. CONFIRMATION OF EXISTENCE AND EXACT LOCATION OF ALL SERVICES MUST BE OBTAINED FROM THE INDIVIDUAL UTILITIES BEFORE PROCEEDING WITH CONSTRUCTION.

SURVEY NOTE REFERENCE:

5	Aug 26/24	Issued For Review	M.P.	c.d.
4	May 24/24	Issued For Construction	M.M.	c.p.
3	April 2/24	Issued For Tender Addendum	M.M.	v.d.
2	June 15/23	Issued For Tender	M.M.	v.d.

No.	DATE	REVISIONS	INIT.
		August 26, 2024	



LANDSCAPE PLAN - TRAIL ENLARGEMENT 'C'

JAYCEE PARK TRAIL

From: BEAVER CRESCENT
To: DUNSDON STREET

APP'D.	DES.	RATIO: HORIZ. 1:250 VERT. 1:100
		DESIGNED BY: MM/VD DRAWN BY: V. DAMONE CHECKED BY: M. PATTIUCCI
		DATE: AUGUST, 2024

PROJECT No. PK 2226 DRAWING No. 2-2439-5